

104 - 515 CHATHAM STREET, OLD TOWN VICTORIA
OPEN CONCEPT RETAIL SPACE WITH HIGH EXPOSURE

**FOR
LEASE**



WILLIAM | WRIGHT

HARRY JONES
PERSONAL REAL ESTATE CORPORATION
harry@williamwright.ca
250.590.5797

CONNOR BRAID
PERSONAL REAL ESTATE CORPORATION
connor@williamwright.ca
250.590.5797

JEFF HASSLER
jeffh@williamwright.ca
250.590.5797



RETAIL OPPORTUNITY

Brand new retail space conveniently located at the corner of Chatham and Store Streets in Victoria's historic Old Town. This retail space has high exposure to both vehicular and pedestrian traffic in a neighbourhood that offers a creative blend of cutting-edge culture, heritage, and character.

LOCAL TENANTS



CAPITAL IRON, BEAN AROUND THE WORLD, CRAFT, JAM CAFE

SALIENT FACTS

SIZE

+/- 1,101 SQFT

PARKING

1 Designated Underground Stall
and Free Street Parking

ZONING

OTD-1

BASIC RENT

\$33.00/FT

ADDITIONAL RENT

\$21.00/FT (Est.)

LANDLORD INDUCEMENTS PACKAGE AVAILABLE

Contact Listing Agents

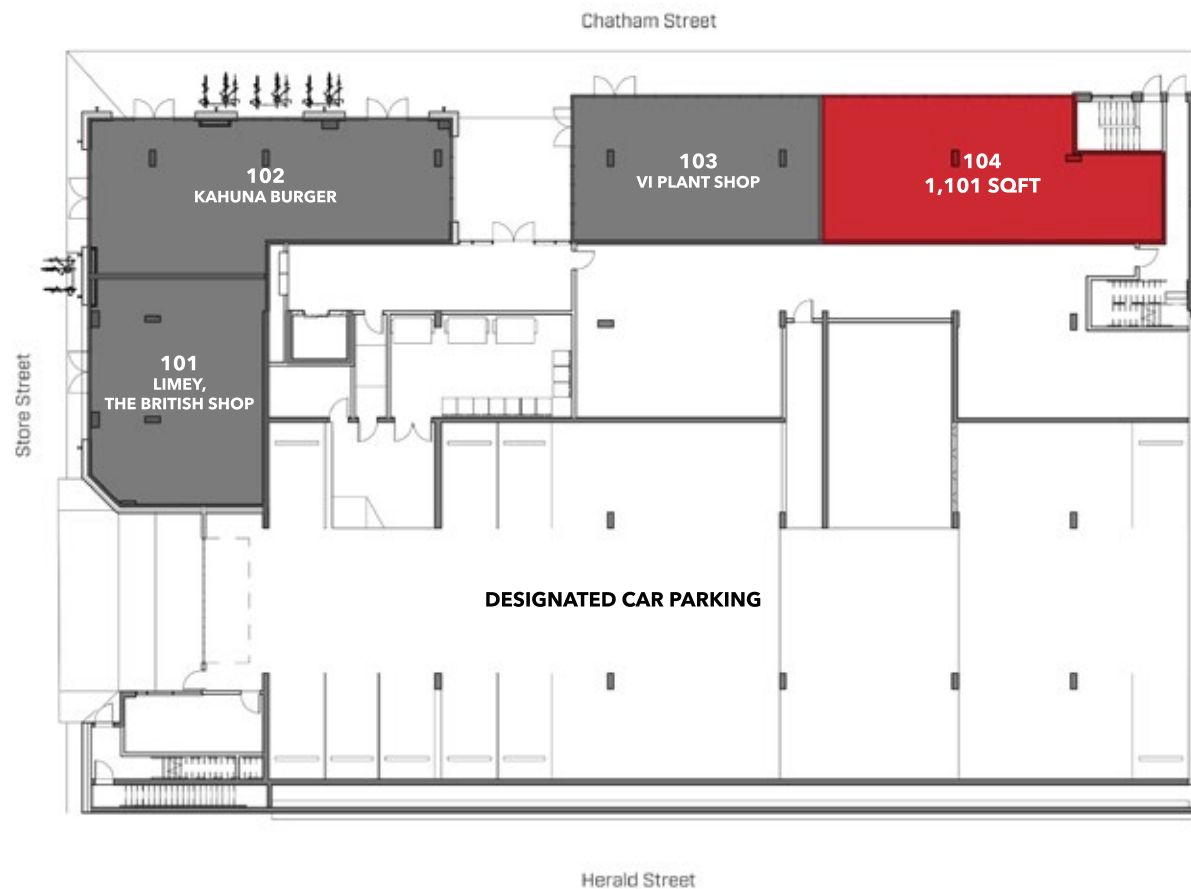



LOCATION & TRANSIT

Old Town is known for its funky local boutiques and restaurants and is home to Canada's oldest Chinatown. 515 Chatham Street is situated right in the heart of Old Town and the area dates back to the early 1900's, linking it to Victoria's past, and has now become part of a whole new iconic streetscape for the modern era. The location is a walker's paradise, with the ability to walk to or bike to complete your daily errands. It is also in close proximity to bus routes 11, 14, 15, 22, and 25.



LeFevre

BUILT DIFFERENT

Le Fevre & Company has made it their duty to enhance the communities they are privileged to operate in.

For over 50 years Chris Le Fevre has been hard at work bringing diverse housing, commercial and resort properties to life while still maintaining a

solid grasp of the importance of heritage buildings and their place in the communities they occupy.

PAST PROJECTS

THE BIGGERSTAFF BUILDING

A warehouse and office complex in downtown Victoria with natural wood floors and recycled timbers from an old bowling alley in Esquimalt.

THE LEISER BUILDING

Reconfigured building into thirty-two living spaces with commercial space on the ground floor.

THE ORIENTAL HOTEL

One of Victoria's most recognized buildings in Old Town has been reborn.

THE NEW ENGLAND HOTEL

Heritage restoration – Old Town apartment rentals and commercial space.

NEW DEVELOPMENTS

The RailYards / Miner's Lane / Desert Living / Woodward's Village / Mountain Living in Revelstoke



FOR MORE INFORMATION CONTACT

HARRY JONES

PERSONAL REAL ESTATE CORPORATION

harry@williamwright.ca

250.590.5797

CONNOR BRAID

PERSONAL REAL ESTATE CORPORATION

connor@williamwright.ca

250.590.5797

JEFF HASSLER

jeffh@williamwright.ca

250.590.5797

williamwright.ca



Vancouver Office

1340-605 Robson Street
Vancouver, BC
604.428.5255

New Westminster Office

350-522 7th Street
New Westminster, BC
604.545.0636

Fraser Valley Office

210-8029 199th Street
Langley, BC
604.546.5555

Victoria Office

843 Johnson Street
Victoria, BC
250.590.5797

Central Island Office

100B-154 Memorial Avenue
Parksville, BC
250.586.1226

Kelowna Office

205-478 Bernard Avenue
Kelowna, BC
236.420.3558

Kamloops Office

406-121 5th Avenue
Kamloops, BC
236.425.1617