

513 - 938 HOWE STREET, VANCOUVER
VIBRANT OFFICE SPACE WITH 24/7 ACCESS TO CONCIERGE

**FOR
LEASE**



WILLIAM | WRIGHT

AMRITA GURAM
amrita@williamwright.ca
604.428.5255





Central Downtown Vancouver location



24/7 access & full time concierge



Front street facing office with lots of natural light



Abundance of amenities in close proximity

OVERVIEW

Located in the heart of Downtown Vancouver, this office building is nestled on a block lined with cafes, shops and restaurants. Pacific Place attracts a large tenant mix ranging from young startups to established businesses and law firms, due to the short distance to the Law Courts Centre.

If you're looking for a vibrant office space in a convenient location, Pacific Place is hard to beat.

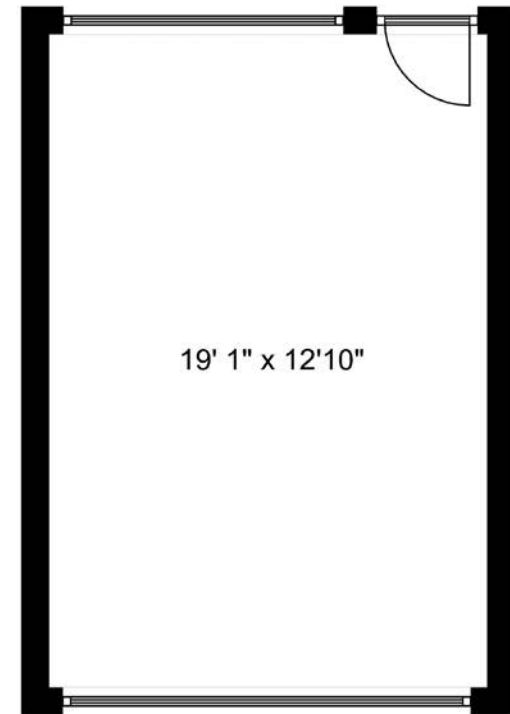

Size	± 253 SQFT
Zoning	CD
Lease Rates	Contact Listing Agent

Disclaimer: Measurements are approximate and shall be verified by the Tenant if deemed important.



FOR MORE INFORMATION CONTACT

AMRITA GURAM

amrita@williamwright.ca

604.428.5255



WALK SCORE
100



TRANSIT SCORE
100



BIKE SCORE
96

LOCATION

Immediately in central downtown, right across from BC Provincial Court House, within walking vicinity to Yaletown & the business district. 5 mins walk to Vancouver City Centre Skytrain Station. Area amenities include Robson Square, Robson St, Pacific Centre & as well highlighting that 938 Howe St becomes very efficient to access to both Granville or Cambie St bridges with Pacific Place on Howe St in between Smithe & Nelson Street.

TRANSIT

The building is located in central downtown, right across from BC Provincial Court House, within walking distance to Yaletown and the business district. Vancouver City Centre SkyTrain Station is less than 5 minutes away.

